

# NOTES

- \*ALL DIMENSIONS ARE IN MILLIMETRES UNLESS SPECIFIED OTHERWISE.
- \*DIMENSIONS SHALL NOT BE SCALED OFF THIS DRAWING
- \*DRAWING WILL BE ISSUED IN DIGITAL FORM / HARD COPIES FOR REVIEW / TENDER / ESTIMATE PURPOSE HOWEVER ONLY HARD COPIES SEALED / SIGNED BY THE DESIGNER SHALL BE USED FOR THE CONSTRUCTION.
- \*WHEN IN DOUBT, DONT MEASURE THE DRAWING,  
DON'T ASSUME ANY THING BUT ASK US(0484) 2203098
- \*STEEL GRADE (Fe 500) FOR ALL BARS
- \*ALL LAPS ARE 55 TIMES DIA OF BAR
- \*CLEAR COVER 50mm FOR ALL BARS IN FOUNDATION
- \*FOR CENTRELINE DIMENSIONS REFER ARCHITECTURAL DRAWINGS ONLY.
- \*CONCRETE MIX M 25 ( ) FOR FOUNDATION
- \*AT JUNCTION OF TWO ELEMENTS OF DIFFERENT CONCRETE MIXES THE COMMON CONCRETE SHALL BE DONE WITH THE RICHER MIX.
- \*CONCRETE MUST BE MACHINE MIXED.
- \*MAXIMUM WATER / CEMENT RATIO USED SHALL BE LIMITED TO 0.50 FOR SLABS AND 0.50 FOR BEAMS AND COLUMNS
- \*CHIPPING OF ANY STRUCTURAL CONCRETE ELEMENTS SHALL NOT BE DONE IN ANY CIRCUMSTANCES UNLESS WITH THE SPECIAL PERMISSION OF CONSULTANTS
- \*ALL COVER SHALL BE ENSURED BY PRECAST COVER BLOCKS MADE UP CM 1:3
- \*FOUNDATION IS DESIGNED FOR G+1 FLOORS
- \*DESIGN BASED ON SOIL REPORT GIVEN BY CLIENT.

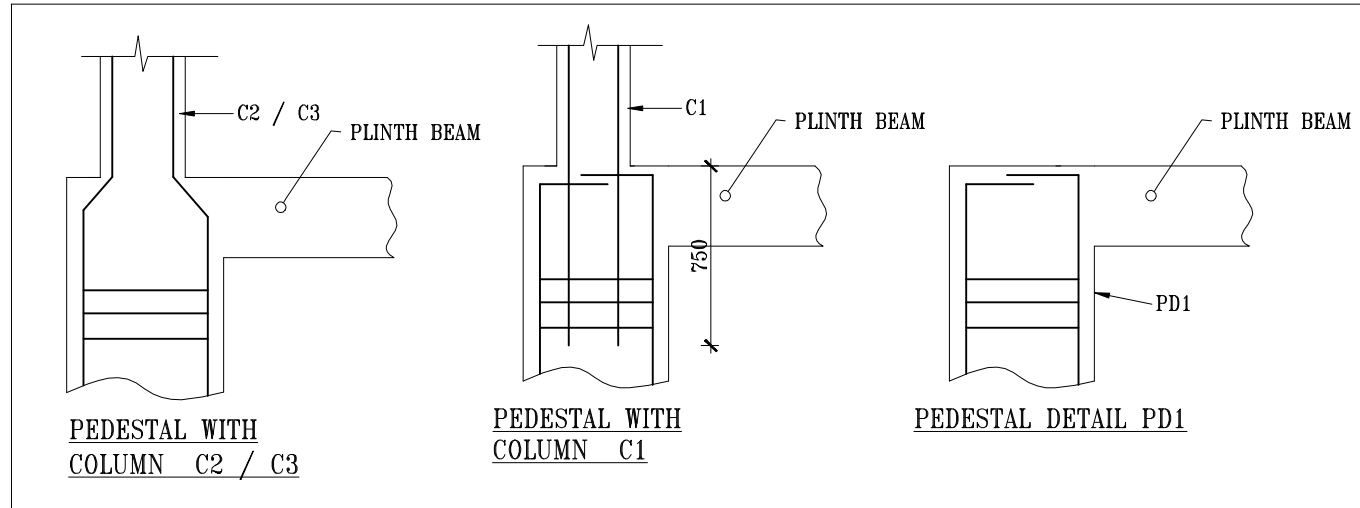

PEDESTAL WITH COLUMN C2 / C3

PEDESTAL WITH COLUMN C1

PEDESTAL DETAIL PD1

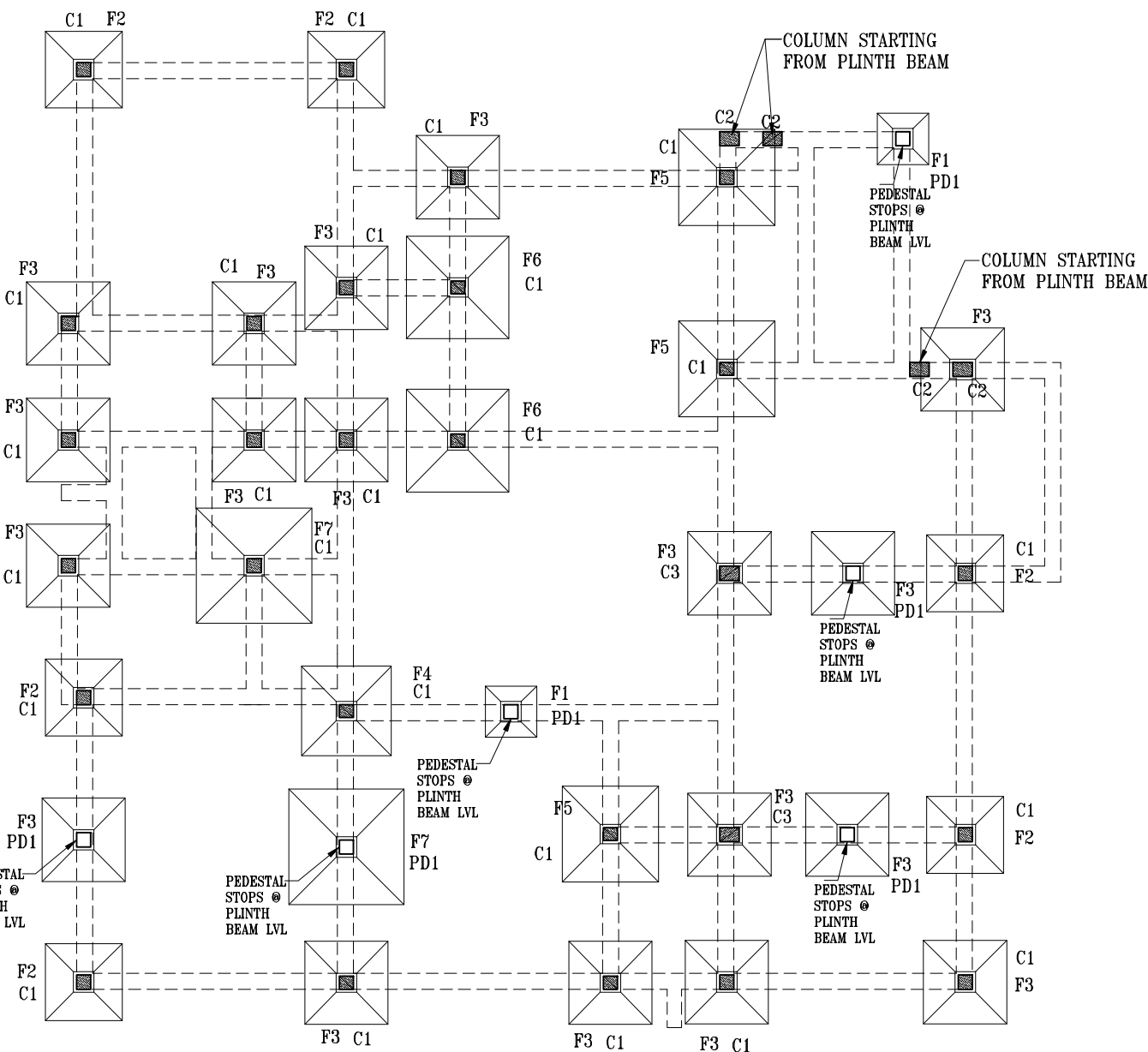

FOUNDATION DETAILS

	PEDESTAL	COLUMN
C1	<p>MIX M30</p> <p>300 x 300</p> <p>8 NOS 12 <math>\bar{\phi}</math></p> <p>8 <math>\bar{\phi}</math> @ 200c/c</p>	<p>200 x 200</p> <p>4 NOS 8 <math>\bar{\phi}</math></p> <p>8 <math>\bar{\phi}</math> @ 200c/c</p>
C2	<p>400 x 300</p> <p>6 NOS 12 <math>\bar{\phi}</math></p> <p>8 <math>\bar{\phi}</math> @ 200c/c</p>	<p>300 x 200</p> <p>6 NOS 12 <math>\bar{\phi}</math></p> <p>8 <math>\bar{\phi}</math> @ 200c/c</p>
C3	<p>400 x 300</p> <p>6 NOS 16 <math>\bar{\phi}</math></p> <p>8 <math>\bar{\phi}</math> @ 200c/c</p>	<p>300 x 200</p> <p>6 NOS 16 <math>\bar{\phi}</math></p> <p>8 <math>\bar{\phi}</math> @ 200c/c</p>
PD1	<p>300 x 300</p> <p>8 NOS 12 <math>\bar{\phi}</math></p> <p>8 <math>\bar{\phi}</math> @ 200c/c</p>	

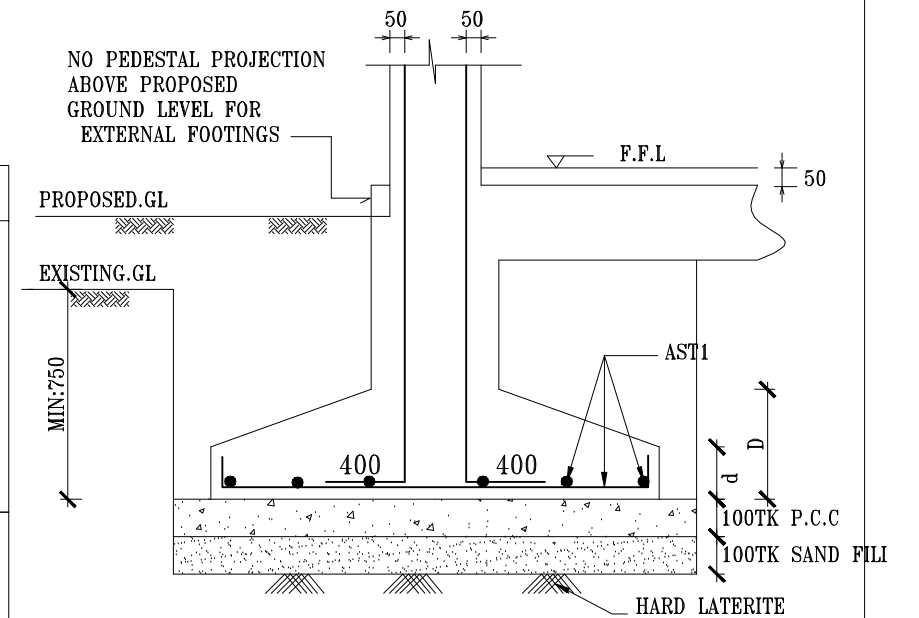

TYPICAL FOOTING SECTION

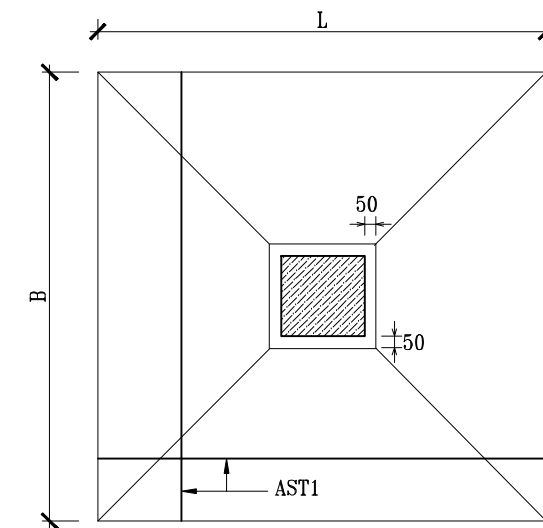

TYPICAL FOOTING PLAN